

TCLPAC10 & TCLPAC12

Portable Air Conditioner with Dehumidifier

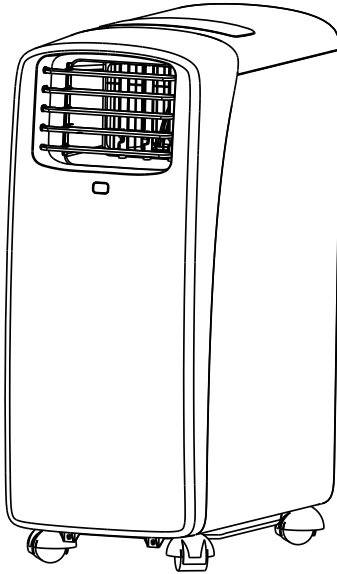

INSTRUCTION MANUAL

PLEASE READ THE INSTRUCTION MANUAL CAREFULLY BEFORE USING THE UNIT.

WARNINGS AND PRECAUTIONS	1
STRUCTURE	3
OPERATION	4
SELF DIAGNOSIS	12
TIPS	13
DRAINAGE	14
CLEANING AND MAINTENANCE	15
TROUBLESHOOTING	16
TECHNICAL REFERENCE DATA	17
WARRANTY	18

IMPORTANT INFORMATION

Carefully read this instruction manual before you install or use your portable air conditioner. Please retain this manual for product warranty and for future reference.

CAUTION

- Use this appliance only as described in this instruction manual. As with all electrical equipment, whilst the instructions aim to cover as many eventualities as possible, caution and common sense should be applied when operating and installing this appliance.
- This appliance is designed for domestic use only and must not be used for any other purposes
- It is dangerous to modify or alter the characteristics of the appliance in any way.
- The appliance must be installed in conformity with national legislation regulating electrical equipment and installations.
- If the appliance requires repair, contact a Service Centre authorised by the manufacturer only. Repairs carried out by unauthorised personnel may be dangerous.
- Young children should be supervised to ensure that they do not play with the appliance.
- The appliance must be connected to an efficient earth system. Have your electrical circuit checked by a qualified electrician.
- Do not use an extension cable with this product.
- Before cleaning or maintenance, always unplug the appliance from the mains socket.
- Never unplug the appliance by pulling on the power cable.
- Do not rest heavy or hot objects on top of the appliance.

- This appliance is not intended for use by persons (including children) with reduced physical, sensory or mental capabilities, or lack of experience and knowledge, unless they have been given supervision or instruction concerning use of the appliance by a person responsible for their safety.
- Do not install the appliance in rooms containing gas, oil or sulphur. Do not install near sources of heat
- Keep the appliance at least 50 cm away from flammable substances (alcohol etc) or pressurised containers (e.g. aerosol cans).
- Clean the air filter at least once a week.
- Avoid using heating appliances near the air conditioner.
- When storing the appliance away, do not cover with plastic bags.
- The materials used for packaging can be recycled. You are therefore recommended to dispose of them in special differentiated waste collection containers.
- If the power cable is damaged, it must be replaced by the manufacturer or an authorised technical service centre in order to avoid all risk.

IMPORTANT

The air conditioner must always be stored and transported upright. In case of doubt we suggest you wait at least 24 hours before operation. (Please keep the unit upright at all times)

PACKAGE CONTENTS

- Portable air conditioner
- Remote control
- Window kit
- Drain hose

STRUCTURE

TCL

1. Air outlet grille
2. Control panel
3. Castors
4. Intake grille
5. Remote control receiver
6. Filter
7. Handles
8. Air exhaust hose housing
9. Condensation drain
10. Power cord
11. Air exhaust hose
12. Hose outlet
13. Hose inlet
14. Window bracket
15. Drain hose*
16. Remote control

* means the accessory is optional.

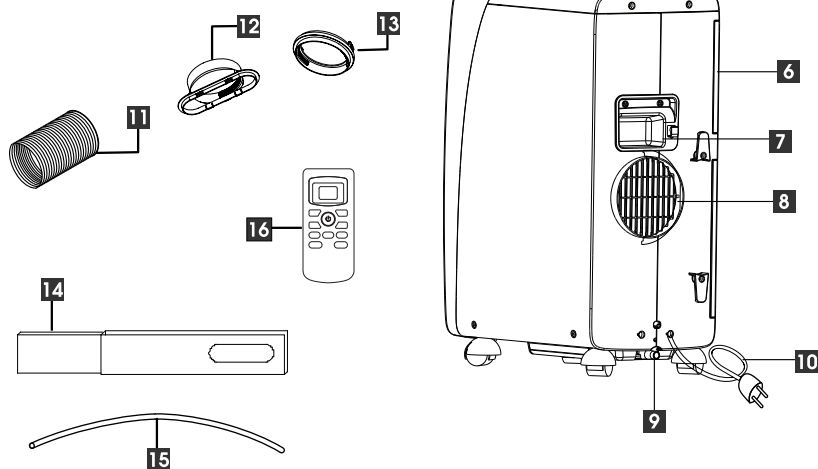
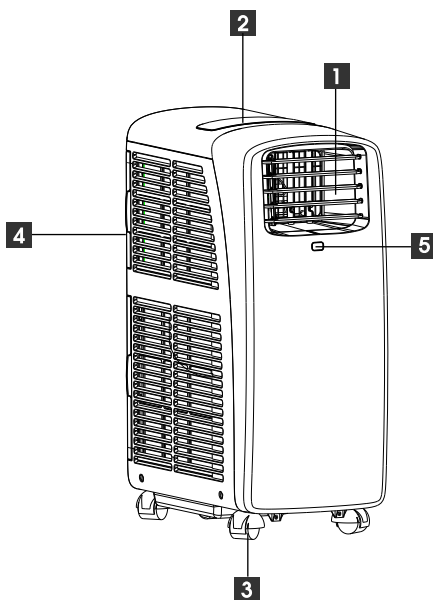

BEFORE FIRST USE

- Please read these instructions carefully before use and keep them for future reference.
- Check your local mains voltage is the same as stated on the appliance.
- Before using for the first time, remove any protective films or stickers from the appliance.

CONTROLS

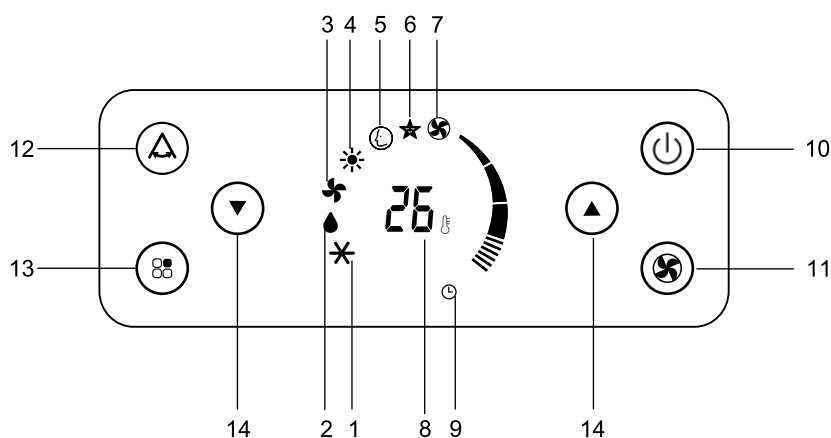

- | | |
|---------------------------------|--|
| 1. COOL symbol | 9. TIMER symbol |
| 2. Dehumidify symbol | 10. ON/OFF button |
| 3. FAN symbol | 11. FAN button |
| 4. HEAT symbol (not applicable) | 12. SWING button (selects the modes) |
| 5. SMART symbol | 13. MODE button |
| 6. SLEEP symbol | 14. Increase (▲) and decrease (▼) button |
| 7. FAN speed indicator | |
| 8. Temperature indicator | |

INSTALLATION

Unpack the unit and ensure the air intake and outlet grilles are unobstructed.

EXHAUST HOSE INSTALLATION

1. Fit the air exhaust hose in the housing at the back of the appliance (fig. 1).
2. Fit the window outlet to the end of the hose.
3. Place the air conditioner near a window or French window. Adjust the length of the hose to reach the window.
4. Make sure the air exhaust hose is unobstructed.
5. Open the window slightly and position the outlet (fig. 2).
6. If you have a sash window, place the bracket on the window sill, extend the bracket fully within the window frame and fix the bracket by using the pin, then lower the window onto the bracket. Insert the window outlet of the exhaust hose into the Slot, then connect the hose to the air conditioner (fig. 3).

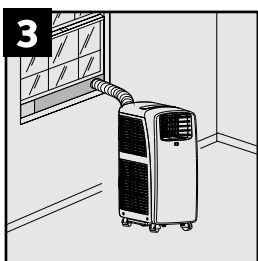
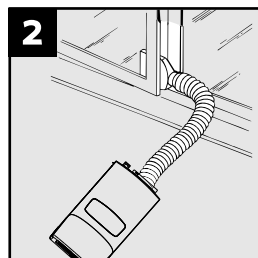
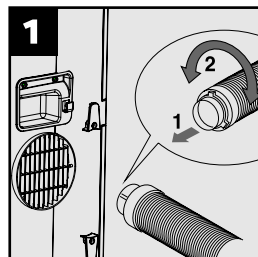

TIP

- Keep the air hose as short and free of curves as possible to avoid bottlenecks.
- When installing the air conditioner semi-permanently, you should leave a door slightly open (as little as 1 cm) to guarantee correct ventilation.

OPERATING FROM THE CONTROL PANEL

TURNING THE APPLIANCE ON

- Plug into the mains socket.
Two lines appear on the display indicating that the appliance is in standby (fig. 4).
- Press the ON/OFF button until the appliance comes on. The last function used when it was last turned off will appear.



NOTE: Never turn the air conditioner off by unplugging from the mains. Always press the ON/OFF button, then wait for a few minutes before unplugging.

COOL MODE

- Press the MODE button until the COOL symbol appears.
- Select the target temperature by pressing the ▲ or ▼, button until the desired value is displayed.
- Select the required fan speed by pressing the FAN button. Four speeds are available:

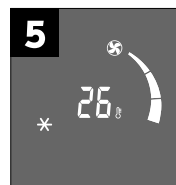

Low speed: for silent operation.

Medium speed: reduces noise levels, but still maintains a good level of comfort.

Maximum speed: to achieve the target temperature as quickly as possible.

AUTO FAN: the appliance automatically selects the most suitable fan speed in relation to the temperature set on the digital display.



DRY MODE



Ideal to reduce room humidity. In dry mode, the appliance should be prepared in the same way as cool mode, with the air exhaust hose attached to enable the moisture to be discharged outside.

- Press the MODE button until the DRY symbol appears.

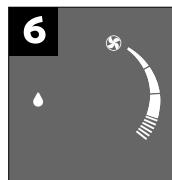

NOTE: In this mode the fan speed is selected automatically by the appliance and can not be set manually.

FAN MODE



- Press the MODE button until the FAN symbol appears
- Select the required fan speed by pressing the FAN button. Three speeds are available:

Low speed: for silent operation.

Medium speed: reduces noise levels, but still maintains a good level of comfort.

Maximum speed: to achieve the target temperature as quickly as possible.



NOTE: When using the appliance in this mode, the air hose does not need to be attached. In this mode, AUTO speed cannot be selected.

SMART MODE



The appliance chooses automatically whether to operate in air conditioning or fan mode.

- Press the MODE button until the SMART symbol appears.

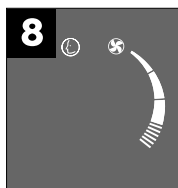

REMOTE CONTROL

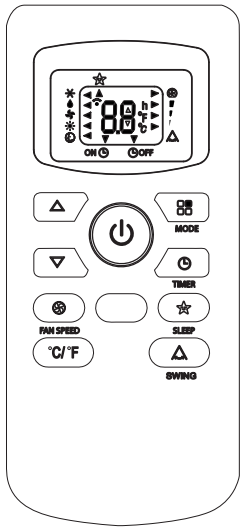

	On/Off button		Fan speed button
	Increase button		Mode button
	Decrease button		Swing button
	Timer button		Sleep button
	Unit Switch button		

	COOL symbol		SLEEP symbol
	DRY symbol		Timer ON symbol
	FAN symbol		Timer OFF symbol
	HEAT symbol		Fan speed symbol
	SMART symbol		
	Swing symbol		

CORRECT USE

- Point the remote control at the receiver on the appliance. The remote control must be no more than 7 metres away from the appliance (without obstacles) .
- The remote control must be handled with extreme care . Do not drop it or expose it to direct sunlight or sources of heat.

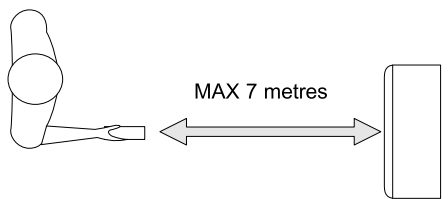

INSERTING OR REPLACING THE BATTERIES

- Remove the cover on the rear of the remote control.
- Insert two “AAA” 1.5V batteries in the correct position (see instructions inside the battery compartment)
- Replace the cover..



NOTE: If the remote control unit is replaced or disposed of, the batteries must be removed and discarded in accordance with current legislation as they are harmful to the environment

USING THE REMOTE CONTROL

Some of the controls on the remote control are the same as those on the control panel of the appliance.

You should therefore refer to the instructions ‘Operating from the control panel’ to turn the appliance on and select the operating mode (COOL, DRY, FAN or SMART) and the fan speed.

The following section describes the additional functions of the remote control.

COOL mode

Ideal for hot muggy weather when you need to cooling and dehumidify the room. To set this mode correctly:

- Press the button a number of times until the ◀ symbol appears next * symbol.
- Select the target temperature 18°C-32°C (64°F -90°F) by pressing the ▲ or ▼ button until the corresponding value is displayed.
- Select the required fan speed by pressing the button.

Four speeds are available: High / Medium / Low / Auto.

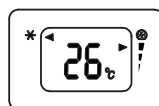
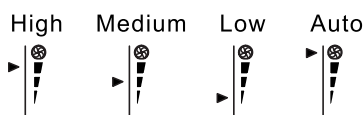

The most suitable temperature for the room during the summer varies from 24 °C to 27 °C (75 °F to 81 °F). You are recommended, however, not to set a temperature much below the outdoor temperature. The fan speed difference is more noticeable when the appliance is under FAN mode but may not be noticeable under COOL mode.

HEAT mode*

“*” means only the heat pump model have this function.

To set this mode correctly:

- Press the button a number of times until the ◀ symbol appears next to the sun symbol.
- Select the target temperature 13 °C - 27 °C (55 °F - 81 °F) by pressing the ▲ or ▼ button until the corresponding value is displayed.
- Select the required fan speed by pressing the button.

Four speeds are available: High / Medium / Low / Auto.



- Water is removed from the air and collected in the tank.
- When the tank is full, the appliance shuts down and “Ft” (full tank) appears on the display. The tank cap must be extracted and emptied. Run off all water left into a basin. When all the water has been drained, put the cap back in place.
- When the tank has been emptied, the appliance starts up again.

N.B.: - When operating in very cold rooms, the appliance defreezes automatically, momentarily interrupting normal operation. “L E” appears on the display. During this operation, it is normal for the noise made by the appliance to change.

- In this mode, you may have to wait for a few minutes before the appliance starts giving out hot air.
- In this mode, the fan may operate for short periods, even though the set temperature has already been reached.

FAN mode

When using the appliance in this mode, the air hose does not need to be attached.

- Press the button a number of times until the ◀ symbol appears next to the fan symbol.
- Select the required fan speed by pressing the button.

Three speeds are available: High / Medium / Low.

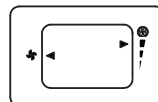

DRY mode

Ideal to reduce room humidity (spring and autumn, damp rooms rainy periods, etc). In dry mode, the appliance should be prepared in the same way as for cool mode, with the air exhaust hose attached to enable the moisture to be discharged outside. To set this mode correctly:

- Press the button a number of times until the ◀ symbol appears next to symbol.
- In this mode, fan speed is selected automatically by the appliance and can not be set manually.

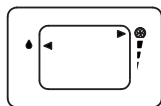

AUTO mode

The appliance chooses automatically whether to operate in cool, fan or heat mode (some certain models have not heat mode).

To set this mode correctly:

- Press the button a number of times until the ◀ symbol appears next to symbol.
- Select the required fan speed by pressing the button. Four speeds are available: High / Medium / Low / Auto.

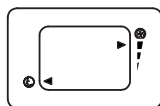

If the appliance is cooling only model, the unit operates in Fan mode when the room temperature is below 23°C (73°F), and Cool mode when the room temperature is above 23°C (73°F).

If the unit is cooling and heating model, the unit operates in Heat mode when the room temperature is below 20°C (68°F), and Fan mode when the room temperature is from 20°C (68°F) to 23°C (73°F), and Cool mode when the room temperature is above 23°C (73°F).

SLEEP function

This function is useful for the night as it gradually reduces operation of the appliance. To set this function correctly:

- Select the cool or heat mode as described above.
- Press the button, and the symbol under symbol.

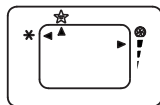

The appliance operates in the previously selected mode.

When you choose the sleep function, the screen will reduce the brightness. The SLEEP function maintains the room at optimum temperature without excessive fluctuations in either temperature or humidity with silent operation. Fan speed is always at Low, while room temperature and humidity vary gradually to ensure the most comfortable.

Switch the unit of temperature

When the appliance is standby, press the °C/°F button, then you can change the unit of temperature.

For example:

Before change, in cool mode, the screen display like fig1.

After change, in cool mode, the screen display like fig2.

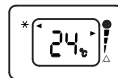

Fig1



Fig2

SETTING THE TIMER

-This timer can be used to delay the appliance startup or shutdown, this avoids wasting electricity by optimising operating periods.

Programming start up

- Turn on the appliance, choose the mode you want, for example cool, 24 °C, high fan speed. Turn off the appliance.
- Press the ⏸ button twice, the screen will display 0.5-24 hours, and the ▼ symbol appears next ON ⏸ symbol and "h" symbol is flash.
- Press the ▲ or ▼ button several times until the corresponding time is displayed. Press the ⏸ button again, the timer will be active, then the ▼ symbol appears next ON ⏸ symbol and time are displayed on screen.
- Press again the ⏸ button or the ⏻ button, the timer will be canceled, and the ▼ symbol disappear next ON ⏸ symbol.

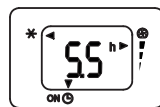

Programming shut down

- When the appliance is running, press the ⏸ button, the screen will display 0.5-24 hours, and the ▼ symbol appears next ⏻OFF symbol and "h" symbol is flash.
- Press the ▲ or ▼ button several times until the corresponding time is displayed. Press the ⏸ button again, the timer will be active, then the ▼ symbol appears next ⏻OFF symbol and time are displayed on screen.
- Press again the ⏸ button or the ⏻ button, the timer will be canceled, and the ▼ symbol disappear next ⏻OFF symbol.

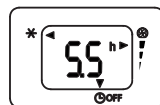

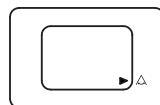

SWING function

- Press the Δ button to enable louver swing function, And the ▶ symbol appears next Δ symbol. The louver will swing right and left. Press this button again to disable the louver swing function.

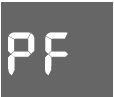

This appliance has a self diagnosis system to identify a number of malfunctions. If an error message is displayed, please refer to the below table.

Error Message	Description	Action
	Low TEMPERATURE (frost prevention)	The appliance is fitted with a frost protection device to avoid excessive formation of ice. The appliance starts up again automatically when the defrosting process is completed.
	PROBE FAILURE (sensor damaged)	If this is displayed, contact your local authorised service centre.
	FULL TANK (safety tank full)	Empty the internal safety tank, following the instructions in the "End of season operations" paragraph.

TIPS

To get the best out of your appliance, please follow the below recommendations.

- Close all windows and doors in the room to be air conditioned. When installing the air conditioner semi-permanently, you should leave a door slightly open (as little as 1 cm) to guarantee correct ventilation.
- Protect the room from direct exposure to sunlight by closing curtains and/or blinds, which makes the appliance much more economical to run.
- Never rest objects of any kind on the air conditioner.
- Do not obstruct the air intake and outlet. Always leave the grilles free.
- Make sure there are no heat sources in the room.
- Never use the appliance in very damp rooms (laundries for example) or outdoors.
- Make sure the air conditioner is on a level surface. if necessary, place the castor locks under the front wheels.

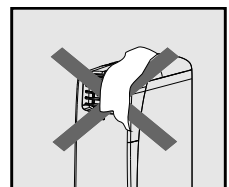
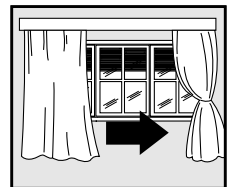
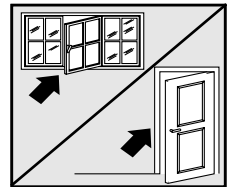

WATER DRAINAGE

This air conditioner is equipped with the very last MIST technology, which means the water tank rarely fills, so water drainage will generally only be required at the end of the season (see start & end of season operation).

NOTE

As a safety measure, and to prevent water spillage, the air conditioner is equipped with a fail safe device if the water tank fills. The unit will stop working and displays the “Ft” error code (FULL TANK). The compressor and fan will not restart until the tank has been emptied.

INTERMITTENT DRAINAGE

- Turn the air conditioner off, then drain the water by unplugging the drain cap and allowing the water to flow into the drain pan. The drain pan will not hold the full contents of the water tank. A number of fills of the drain pan are required. It may be easier (after 3 or 4 pans have been draining in order to avoid spillage when moving the air conditioner) to wheel the unit outside, remove the drain cap and drain the water on the ground.
- The water tank is considered sufficiently empty when no more water flows from the drain outlet. To completely drain all water from the water tank, tilt the unit by lifting it slightly upwards from the front until no more water drains out.
- Restart the air conditioner by pressing the ON/OFF button. Ensure the unit is in the COOL or DRY mode. The compressor will start approx. 3 minutes after the unit is turned on.

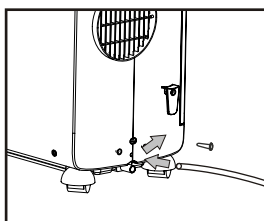
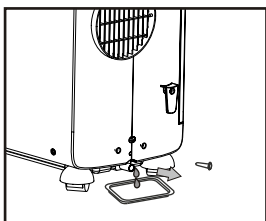

NOTE: If a drain pan wasn't provided, use a bucket or something similar.

CLEANING THE FILTERS

WARNING: Always unplug the unit before moving or before any cleaning.

- To keep your air conditioner working efficiently, you should clean the filter every week of operation.
- The filters are housed in the intake grille (see fig. below).
- Use a vacuum cleaner to remove dust from the filter. If it is very dirty, immerse in warm water and rinse a number of times. The water should never be hotter than 40°C. After washing, leave the filter to dry completely and then attach the intake grille to the appliance.

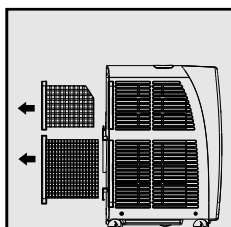

CLEANING THE EXTERIOR

- You should clean the appliance with a slightly damp cloth then dry with a soft dry cloth .
- Never wash the air conditioner with water.
- Never use petrol, alcohol or solvents to clean the appliance.

START & END OF SEASON

Ensure the power cable and plug are undamaged and the earthing is sufficient.

- Empty the internal circuit completely of water as described above.
- Clean & replace the filters as described above.

If you are experiencing any issues, please refer to the below table before calling customer care.

Problem	Cause	Solution
The air conditioner does not turn on.	<ul style="list-style-type: none"> • There is no current. • It is not plugged into the mains • The internal safety device has tripped. 	<ul style="list-style-type: none"> • Wait. • Plug into the mains. • Wait 30 minutes, if the problem persists, contact customer care.
The air conditioner works only for a short time.	<ul style="list-style-type: none"> • There are bends in the air exhaust hose. • Something is preventing the air from being discharged. 	<ul style="list-style-type: none"> • Position the exhaust hose correctly, keeping it as short and free of curves as possible to avoid bottlenecks. • Check and remove any obstacles obstructing air discharge
The air conditioner works, but does not cool the room.	<ul style="list-style-type: none"> • Windows, doors and/or curtains are open. • There are heat sources in the room (oven, hairdryer, etc) • The air exhaust hose is detached from the appliance • The technical specification of the appliance is not adequate for the room in which it is located. 	<ul style="list-style-type: none"> • Close doors, windows and curtains, bearing in mind the "tips for correct use" given above • Eliminate the heat sources. • Fit the air exhaust hose in the housing at the back of the appliance.
During operation, there is an unpleasant smell in the room.	<ul style="list-style-type: none"> • Air filter is clogged. 	<ul style="list-style-type: none"> • Clean the filter as described above.
The air conditioner does not operate for about three minutes after restarting.	<ul style="list-style-type: none"> • The internal compressor safety device prevents the appliance from being re-started until three minutes have elapsed since it was last turned off. 	<ul style="list-style-type: none"> • Wait. This delay is part of normal operation.
The following message appears on the display: Lt / PF/ Ft	<ul style="list-style-type: none"> • The appliance has a self diagnosis system to identify a number of malfunctions. 	<ul style="list-style-type: none"> • See the SELF-DIAGNOSIS chapter.

- Do not dispose of electrical appliances as unsorted municipal waste.
- Use separate collection facilities.



- Contact your local government for information regarding the collection systems available.
- If electrical appliances are disposed of in landfills or dumps, hazardous substances can leak into the ground water, polluting the food chain and damaging health and well-being.

MAINTENANCE

If the unit fails to operate efficiently, is broken or other problems arise, unplug and do not operate. Ask for advice by calling your local after sales service agent or the Customer Care Centre on 1300 556 816.

MODEL NO.	TCLPAC10	TCLPAC12
Rated Power Cooling	1170W	1300W
Cooling Capacity	3kW	3.5kW
Voltage/Frequency	220-240V/50Hz	220-240V/50Hz
Dimensions Body (HxWxDmm)	695 x 270 x 480	695 x 270 x 480
Refrigerant	R410A	R410A
RCM	5336	5336

WARRANTY

The warranty period is 24 months from the date of purchase. For service advice, please contact the Customer Care Centre on 1300 556 816 (AU) / 0800 666 2824 (NZ).

Glen Dimplex Australia Pty Ltd
1340 Ferntree Gully Road,
Scoresby 3179, Victoria
Australia
Ph: 1300 556 816